

Warranty



Thank you for choosing a BLANCO product.

We deliver our products with a good quality and provide 2-years-warranty with our customers . In case of heavy damage and malfunction due to our manufacturing or structural defects, poor materials, etc. We will repair or replace it free of charge within the warranty period.

Model name/product number		
Delivery date		YYYY/MM/DD
Customer	Name	
	Address	
	Phone	— —
Dealer	Name	
	Address	
	Phone	— —

This warranty promises a free repair or a free replacement to the defects that occur under normal use despite of according to the instruction manual under the warranty period.

This warranty excludes the defects that are not related to the product itself, such as connections to drainage or overflow parts or connections to the top plate.

This warranty is valid for 2 years from the date of delivery written in above form by the person in charge.

If you request a free repair or replacement, present this page to the store, the installation company, or the building management company which you purchased from.

This warranty is valid only when all information are filled out on the upper registration form.

This warranty page will not be reissued. Please keep it in a safe place.

This warranty is valid only in Japan.

THIS WARRANTY IS NOT ADAPTED IN THE FOLLOWING CASES REGARDLESS OF THE WARRANTY PERIOD

Defects not due to the product, but due to carelessness or negligence in the installation of parts to the product, installation of the top plate, or construction.

Defects caused by reasons other than the product, such as deformation of the building frame.

Defects caused by the use of non-genuine parts.

Defects caused by improper usage of the product.

Defects caused by improper repair, modification, or disassembly.

Malfunctions caused by falling or strong impact during transportation or installation.

Defects due to deterioration over time under the normal use.

Failures caused by sand or red rust inside the pipes

Failures caused by fire, earthquake, water damage, lightning, freezing, or other natural disasters, earthquakes, or special weather or environmental conditions.

Failures caused by the use in highly corrosive environments, such as near the coast or hot springs.

No presentation of this warranty page, or insufficient information on the upper registration form.

BLANCO

KITCHEN FAUCET INSTRUCTION MANUAL

[INDEX]

Safety Precautions P.2
 Parts Name..... P.3
 Function..... P.4
 Care and Maintenance P.5
 Troubleshooting P.6
 Warranty P.8

Installation conditions

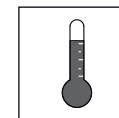

Max.70°

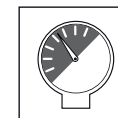

Max.1Mpa

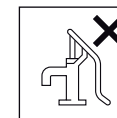

No Well Water

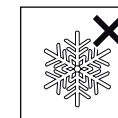



No Cold Weather

Safety precautions







After reading this instruction manual, be sure to keep it in a place where the user can access it at any time.
 When transferring this product to another person, be sure to attach this instruction manual.
 The manufacturer has no product liability of any damage to persons or properties, the damage which are caused by not following this instruction manual and installation manual.
 The manufacturer has no product liability of any harm to persons or properties, the damage which are caused by modification or repair by the user.





■ These signs indicate the degree of harm or damage that can occur if it is used incorrectly.

 WARNING RISK OF DEATH OR SERIOUS INJURY	 CAUTION RISK OF INJURY OR PROPERTY DAMAGE
--	--

■ These signs indicate the contents to be observed.

 MUST FOLLOW	 SHOULD NOT DO
--	--

 WARNING	
	Supply water temperature up to 70° May cause damage to water faucets and hoses. Also may cause water leakage which result in damage to household goods and other property.
	Do not attach water purifier Can not be installed because of its structure.
	Do not install, disassemble, or replace parts of the faucet except for a specialist Do not anything more than this instruction manual.
	Regular check with loose, rattling, or leaking of the faucet Check the main unit, water supply connection hose, etc. To ensure that no parts have become loose through lifetime and usage.
	Make sure that water supply pressure is equal to or higher than hot water supply Ensure correct temperature control.

 CAUTION	
	Do not put anything on the spout or handle May cause damage to the faucet
	Do not use nylon scrubbers or sharp objects for cleaning May cause scratches or damage to the faucet surface
	Do not use solvents such as thinner or benzene for cleaning May cause peeling or deterioration of the paint, or damage to rubber or resin parts

Parts Name

*This faucet is for the purpose of parts name and their locations.
 *Design and specifications are subject to change without notice.

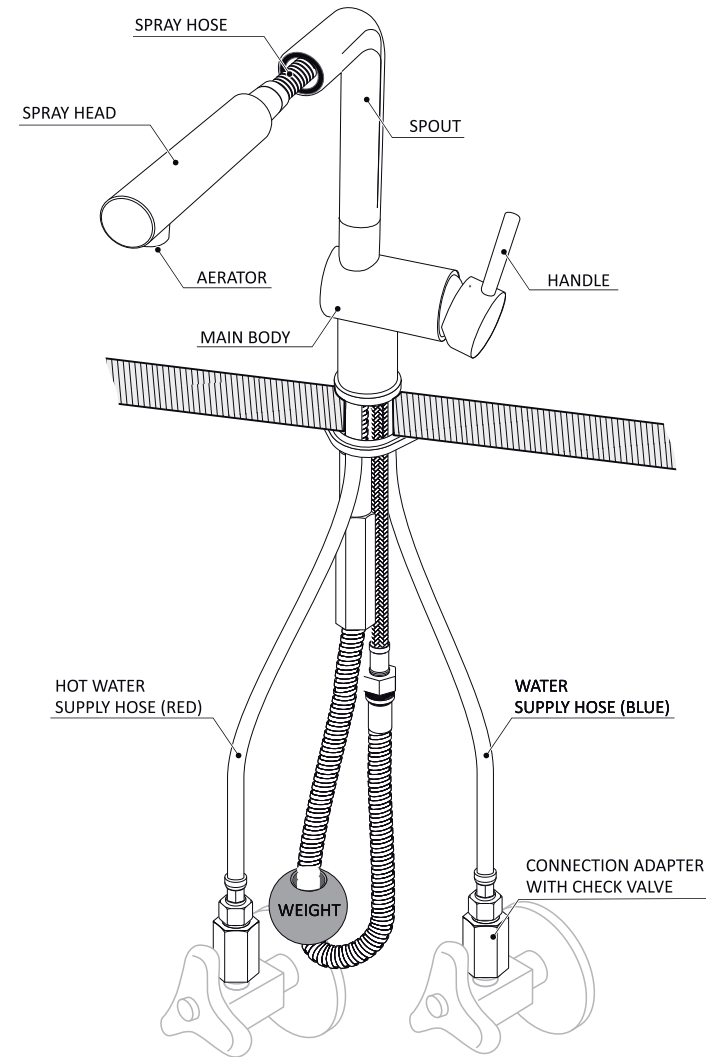

Function

This faucet illustration is a representative model.

The arrow indicates the direction of spout rotation, "open / close", and "hot / cold".

Movement

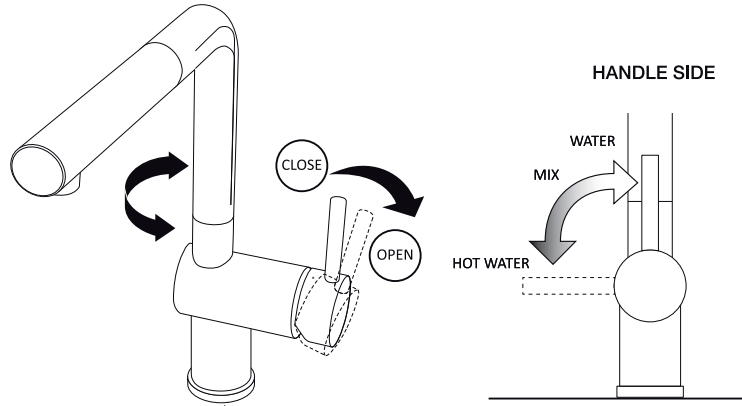

Spray head

Pull out the spray head from the spout. Make sure to return it firmly when put it back.

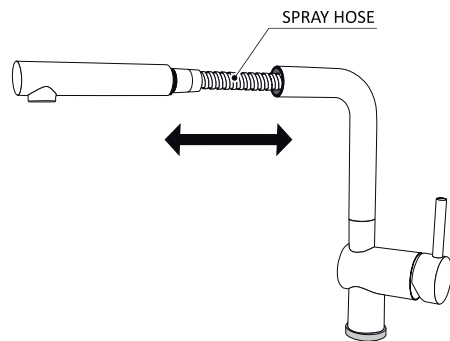

✗ BAD EXAMPLE

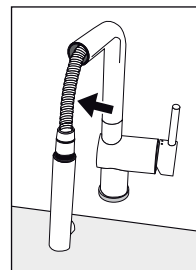

Insufficient return may cause damage to the hose.

Care and Maintenance

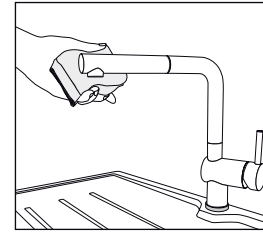

Daily care

To keep your faucet clean, please clean and maintain it carefully. Gently clean the main unit with the soft side of the sponge. Use a neutral detergent. Finish by dry-wiping with a microfiber cloth for added shine.



Do not use abrasives, steel wool or sharp tools as they may damage the product surface.

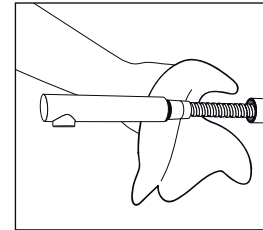

Spray hose care

Be careful not to twist or bend the hose during use intentionally. If the hose becomes hard to return, wipe off any dirt on the hose.

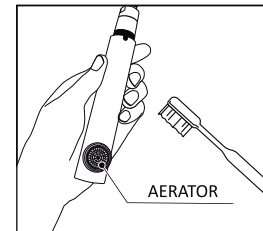

In case of weak water supply and wrong direction spray

There may be water stains stuck to the aerator. Pull out the spray head and use a brush or toothpick to remove water stains from the spout. Using a small amount of citric acid or vinegar dissolved in water will make it easier to remove water stains. After rinsing thoroughly with water, finish by wiping dry with a soft cloth or microfiber cloth.

